

## WING- AND CONCRETE PLATE SET



### Wing set

The wing set is used for anchoring poles and bollards for direct burial. It is supplied in three sizes suitable for poles and bollards with a base diameter of up to 200 mm.

The wing set consists of two aluzinc steel plates, in thicknesses of 1.5 mm and 2.0 mm respectively, assembled with four galvanised screws around the base tube of the pole. Compared to galvanised zinc plates, aluzinc offers up to six times longer service life.

See DAV NORDIC's installation guide for a detailed description of wing set installation.

### Concrete plate set

The concrete plate set is used for poles and bollards for direct burial. The concrete plate set is suitable for poles and bollards with a base diameter from Ø 100–175 mm.

# STANDARD PRODUCTS

## Wing set

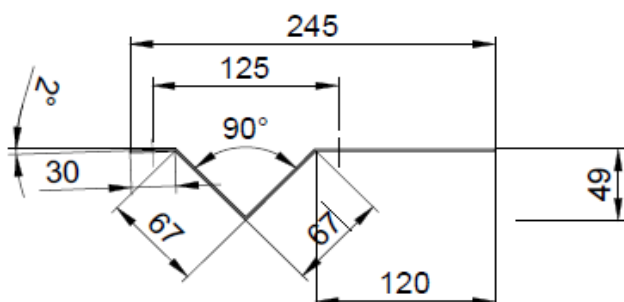

Item no.	Ø pole (mm)	Model	Height/Width (mm)
76174	75-115	Vingefundament	200/370
76188	100-160	Vingefundament	200/370
76193	160-205	Vingefundament	200/504

## Concrete plate set

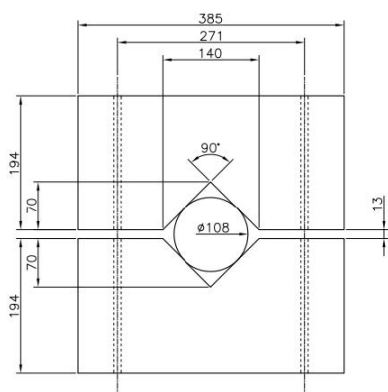

Item no.	Ø pole (mm)	Model	Threaded rod (mm)	Dimensions (mm)
76205	102-130	Pladefundament	500	100/445/260
76200	114-165	Betonpladesæt	500	100/442/400

DAV NORDIC A/S  
Tietgensvej 12  
DK-8600 Silkeborg

DAV NORDIC A/S  
Pilebækvej 5  
DK-4632 Bjæverskov

DAV NORDIC A/S  
+45 86822900  
info@davnordic.dk

